



F65701 Safety Pail Pump

WARNING

Any pump used to transfer flammable liquids must be stored in a well ventilated area.

PERSONAL SAFETY

1. Wear safety glasses at all times when working with this pump.
2. Wear a face shield, proper apparel and suitable respiratory equipment when pumping hazardous chemicals.
3. Keep work area clean, uncluttered and properly lighted.
Replace all unused tools and equipment.

WARNING

Failure to follow all general safety information can result in a fatality, personal injury and/or property damage!



- 1 Remove cap from pail lid
- 2 Ensure nozzle is pushed all the way into the lid

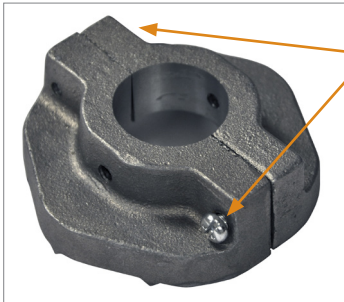

- 3 Loosen the two screws so adapter can fit over metal ring that holds spout in place. Lightly tighten each screw evenly until they grab firmly onto the metal ring. Continue until tight.



- 4 Ridges on bottom of adapter should scrape away paint on lid as adapter is tightened around metal ring.

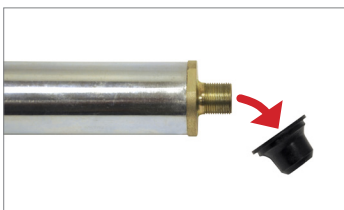

- 5 Remove protective cap from bottom of the pump.

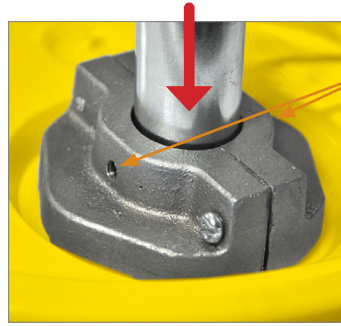

- 6 Slide pump through the adapter hole and tighten set screws (with allen wrench) in center of adapter to touch the pump body. Note: Be careful not to overtighten or dent the pump

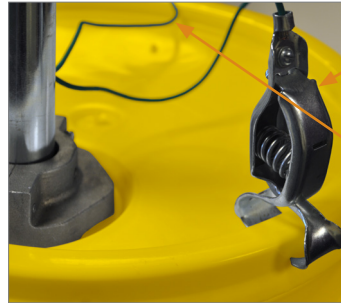

- 7 Attach short grounding wire clip to edge of pail.
- 8 Attach long grounding wire clip to a different metal source not connected to pail or pump.

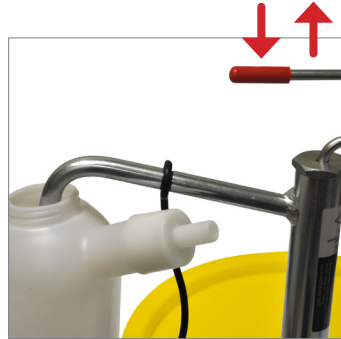

- 9 Take empty container and place below the discharge spout. Start operating the pump handle by moving it up by about 12" and then down. Within a maximum of 4 strokes, pump will start dispensing media.
NOTE: Never take the pump handle to its extreme top position, but operate within a convenient lift height.

ALWAYS DEPRESSURIZE SPRAYER BEFORE REMOVING ANY PARTS.



- 10 Remove compressed air sprayer cap from sprayer.



- 11 Pour media from container into compressed air sprayer.

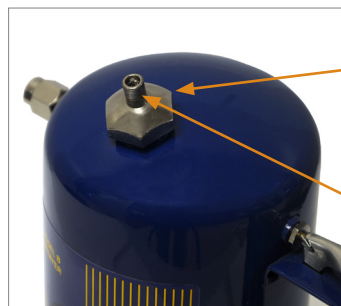

- 12 Reattach compressed air sprayer cap.
- 13 Attach shop air to air sprayer cap



F65701 Safety Pail Pump

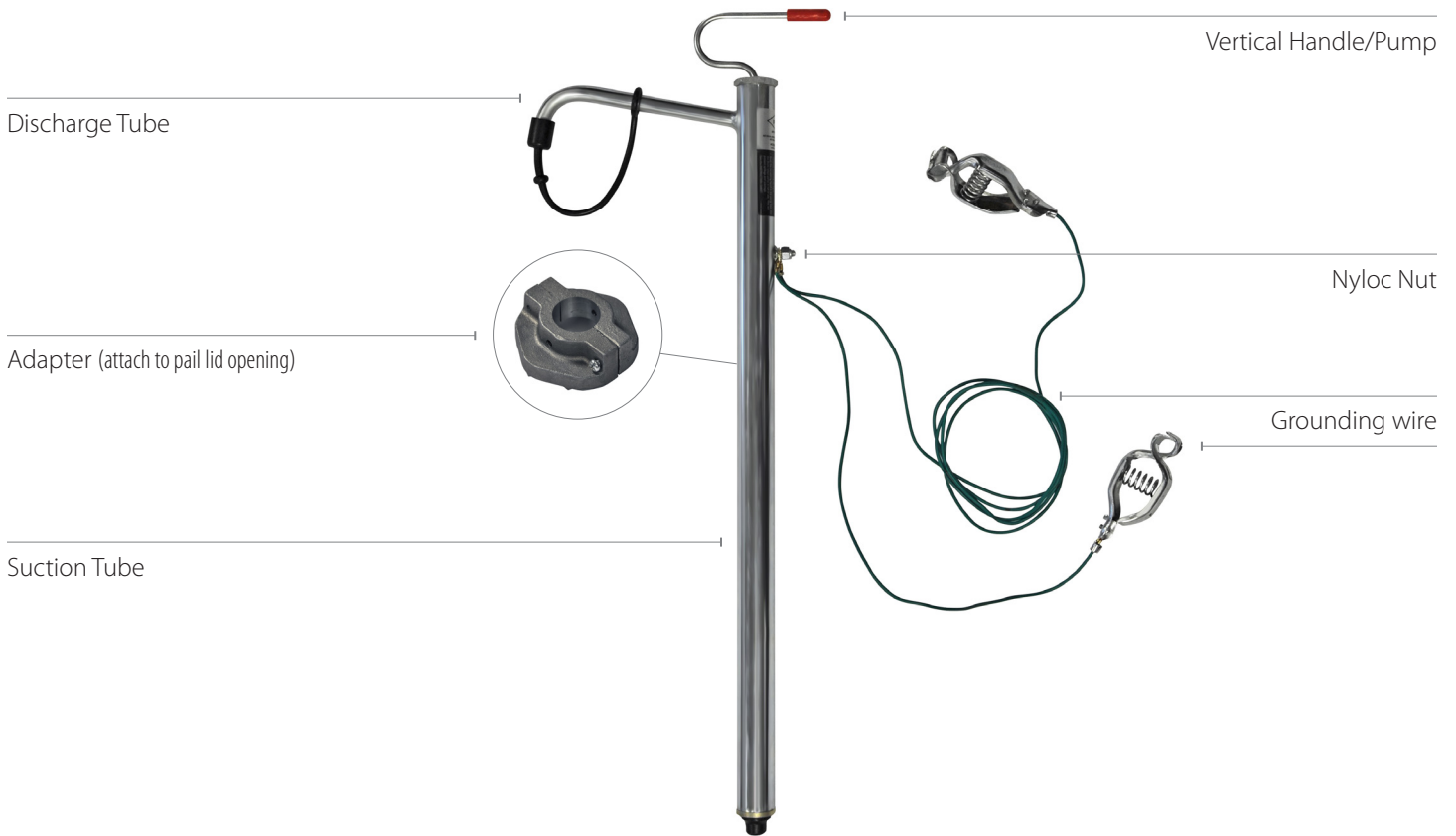

TROUBLESHOOTING

SYMPTOM	POSSIBLE CAUSES	CORRECTIVE ACTION
Pump does not dispense fluid or does not prime.	1. Pump is drawing in air instead of fluid.	1. Tighten suction tube with the pump inlet. Inspect pump cover(s) and seals for leaks. Tighten fasteners and replace seals.
	2. Suction tube inlet is clogged.	2. Remove suction tube & clean tube inlet.
Handle difficult or impossible to move.	1. Pump has not been used for a long time.	1. Remove pump cover and inspect for deposits on components and corroded parts. Clean or replace parts. Flush pump with the media being used if pump is not in use over long periods of time.
	2. Damaged or worn pump parts.	2. Remove pump cover & inspect internal parts. Replace worn or damaged parts.